

To appropriate the Public Waters of the State of Oregon

I, George W. Smith (Name of applicant)
of Box 206 Coos River Rt. Coos Bay (Mailing address)
State of Oregon, do hereby make application for a permit to appropriate the following described public waters of the State of Oregon, SUBJECT TO EXISTING RIGHTS:

If the applicant is a corporation, give date and place of incorporation

1. The source of the proposed appropriation is Smith Creek and spring (Name of stream)
a tributary of Coos River

2. The amount of water which the applicant intends to apply to beneficial use is 1.14 cts.
cubic feet per second. Smith Creek 1.1 spring 0.04 cts.
(If water is to be used from more than one source, give quantity from each)

*3. The use to which the water is to be applied is irrigation 1.1 cts.
(Irrigation, power, mining, manufacturing, domestic supplies, etc.)
domestic: 0.03 from spring and stk.; 0.01 from spring

4. The point of diversion is located ft. and ft. from the
(N. or S.) (E. or W.)
corner of
(Section or subdivision)

- 1. 3060' north; 840' east within SW 1/4 NE 1/4
- 2. 570' north; 760' east " SW 1/4 SE 1/4
- 3. 1380' north; 75' west " NE 1/4 SW 1/4
(If preferable, give distance and bearing to section corner)

All from S 1/4 cor.
(If there is more than one point of diversion, each must be described. Use separate sheet if necessary)
being within the of Sec. 27, Tp. 25 S
(Give smallest legal subdivision) (N. or S.)

R. 12 W, W. M., in the county of Coos
(E. or W.)

5. The Pipe Line (Main ditch, canal or pipe line) to be 1500' (Miles or feet)
in length, terminating in the SW 1/4 SE 1/4 of Sec. 27, Tp. 25 S
(Smallest legal subdivision) (N. or S.)

R. , W. M., the proposed location being shown throughout on the accompanying map.
(E. or W.)

DESCRIPTION OF WORKS

Diversion Works—

6. (a) Height of dam feet, length on top feet, length at bottom feet; material to be used and character of construction
(Loose rock, concrete, masonry, rock and brush, timber crib, etc., wasteway over or around dam)

(b) Description of headgate
(Timber, concrete, etc., number and size of openings)

(c) If water is to be pumped give general description 5 HP. Electric
(Size and type of pump)

(Size and type of engine or motor to be used, total head water to be lifted, etc.)

*A different form of application is provided where storage works are contemplated.
**Application for permits to appropriate water for the generation of electricity, with the exception of municipalities, must be made to the Hydroelectric Commission. Either of the above forms may be secured, without cost, together with instructions by addressing the State Engineer, Salem, Oregon.

Exhibit: 6
Date: 5/2/19

7. (a) Give dimensions at each point of canal where materially changed in size, stating miles from headgate. At headgate: width on top (at water line) feet; width on bottom feet; depth of water feet; grade feet fall per one thousand feet.

(b) At miles from headgate: width on top (at water line) feet; width on bottom feet; depth of water feet; grade feet fall per one thousand feet.

(c) Length of pipe, ft.; size at intake, in.; size at ft. from intake in.; size at place of use in.; difference in elevation between intake and place of use, ft. Is grade uniform? Estimated capacity, sec. ft.

8. Location of area to be irrigated, or place of use

Township North or South	Range E. or W. of Willamette Meridian	Section	Forty-acre Tract	Number Acres To Be Irrigated
25 S	12W	27	SE 1/4 NE 1/4 (lot 4)	32 acres + stk.
			SW 1/4 NE 1/4 (lot 3)	28 acres
			NW 1/4 SE 1/4	16 "
			NE 1/4 SE 1/4	stk.
			SW 1/4 SE 1/4	12 acres
		26	SW 1/4 NW 1/4 (lot 5)	dom.
		100-200	head cattle	

(If more space required, attach separate sheet)

(a) Character of soil Loam

(b) Kind of crops raised pasture

Power or Mining Purposes—

9. (a) Total amount of power to be developed theoretical horsepower.

(b) Quantity of water to be used for power sec. ft.

(c) Total fall to be utilized feet.
(Head)

(d) The nature of the works by means of which the power is to be developed

(e) Such works to be located in of Sec.
(Legal subdivision)

Tp., R., W. M.
(No. N. or S.) (No. E. or W.)

(f) Is water to be returned to any stream?
(Yes or No)

(g) If so, name stream and locate point of return

....., Sec., Tp., R., W. M.
(No. N. or S.) (No. E. or W.)

(h) The use to which power is to be applied is

(i) The nature of the mines to be served

10. (a) To supply the city of
..... County, having a present population of
(Name of)
and an estimated population of in 19.....

(b) If for domestic use state number of families to be supplied: 3 families

(Answer questions 11, 12, 13, and 14 in all cases)

- 11. Estimated cost of proposed works, \$ 3000.00
- 12. Construction work will begin on or before complete
- 13. Construction work will be completed on or before complete
- 14. The water will be completely applied to the proposed use on or before complete

George W. Smith
(Signature of applicant)

Remarks:

1. West half (W $\frac{1}{2}$) of the Southeast quarter (SE $\frac{1}{4}$) of Section
Twentyseven (27), Township Twentyfive (25) South, Range Twelve
(12) West of the Willamette Meridian, Coos County, Oregon.

2. Government lot five (5), in Section Twentysix (26)
Township Twentyfive (25) South, Range Twelve (12) West of the
Willamette Meridian, Coos County, Oregon.

3. Government lots Three (3) and Four (4) in Section Twenty-
seven (27), Township Twentyfive (25) South, Range Twelve (12)
West of the Willamette Meridian, Coos County, Oregon.

STATE OF OREGON, }
County of Marion, } ss.

This is to certify that I have examined the foregoing application, together with the accompanying
maps and data, and return the same for Completion:

In order to retain its priority, this application must be returned to the State Engineer, with correc-
tions on or before January 29th 1968.

WITNESS my hand this 29th day of November 1968.

RECEIVED
DEC 5 1968
STATE ENGINEER
SALEM OREGON

CHRIS L. WHEELER
STATE ENGINEER
By *Larry W. Jebousek*
LARRY W. JEBOUSEK
ASSISTANT

PERMIT

STATE OF OREGON, }
County of Marion, } ss.

This is to certify that I have examined the foregoing application and do hereby grant the same, SUBJECT TO EXISTING RIGHTS and the following limitations and conditions:

The right herein granted is limited to the amount of water which can be applied to beneficial use and shall not exceed 1.12 cubic feet per second measured at the point of diversion from the stream, or its equivalent in case of rotation with other water users, from Smith Creek and a spring

The use to which this water is to be applied is irrigation, domestic use of three families and stock being 1.10 cfs from Smith Creek for irrigation, 0.01 cfs for domestic and 0.01 cfs for stock from spring

If for irrigation, this appropriation shall be limited to 1/60th of one cubic foot per second or its equivalent for each acre irrigated and shall be further limited to a diversion of not to exceed 2 1/2 acre feet per acre for each acre irrigated during the irrigation season of each year.

and shall be subject to such reasonable rotation system as may be ordered by the proper state officer.

The priority date of this permit is November 25, 1968

Actual construction work shall begin on or before May 23, 1970 and shall thereafter be prosecuted with reasonable diligence and be completed on or before October 1, 1971

Complete application of the water to the proposed use shall be made on or before October 1, 1972

WITNESS my hand this 23rd day of May, 1969

Chris J. Wheeler
STATE ENGINEER

PC

Application No. 45606
Permit No. 33989

PERMIT
TO APPROPRIATE THE PUBLIC
WATERS OF THE STATE
OF OREGON

This instrument was first received in the office of the State Engineer at Salem, Oregon, on the 22nd day of November, 1968, at 8:00 o'clock A. M.

Returned to applicant:
Approved:
May 23, 1969

Recorded in book No. 33989 of
Permits on page 101

CHRIS J. WHEELER
STATE ENGINEER
Drainage Basin No. 17 page 101
3870
Fees

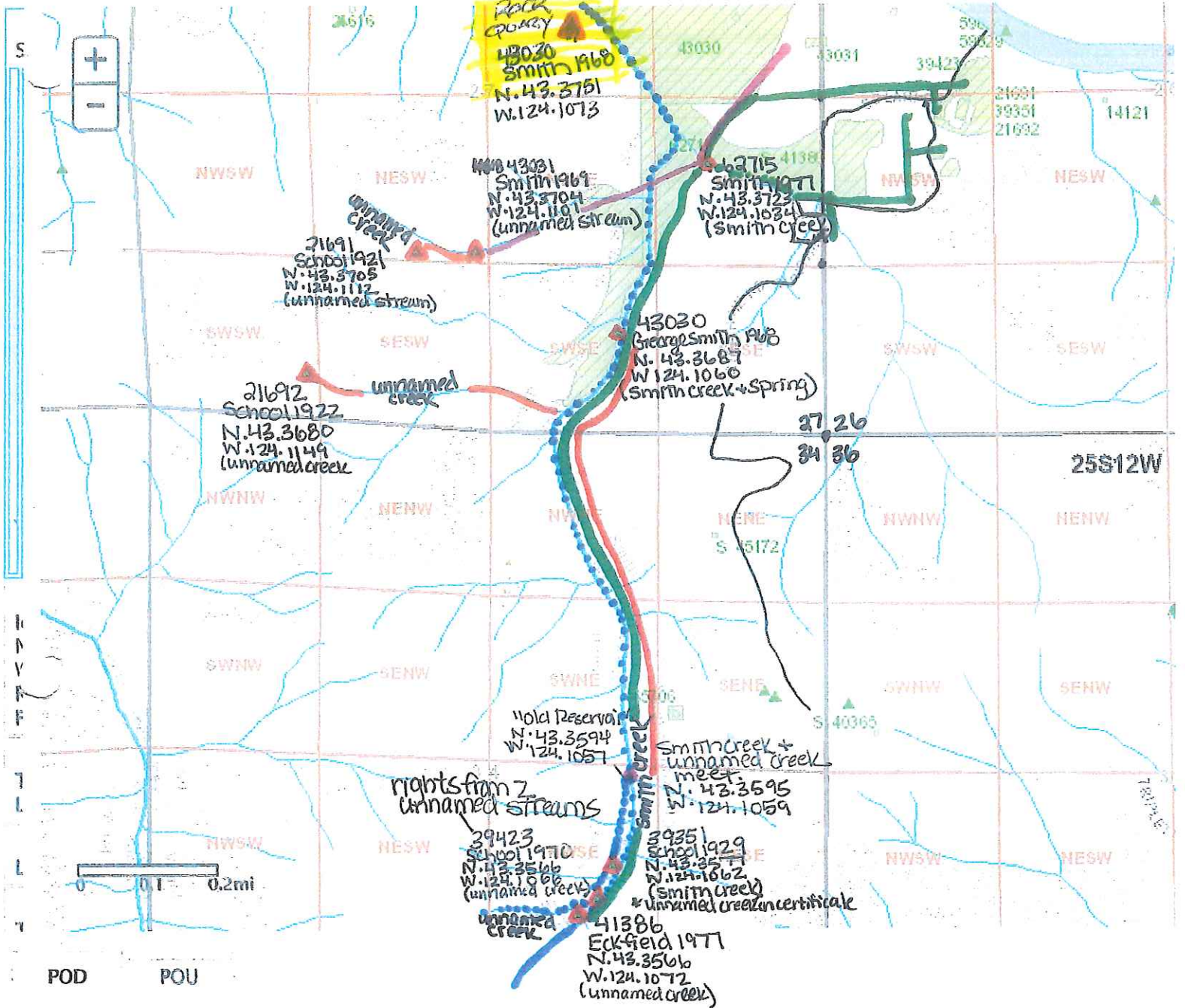

- Waterway
- Roadway
- upper Coos River water system pipelines
- George Smith pipelines
- Waterlines no longer used by school/UCRWSA
- Old pipeline